

BA1 Smart Fridge Microstore

FoodSpot

UNATTENDED MICROSTORES

Product Specifications

External Dimensions: W30" x D39" x H80"
Total Shelf Space: 13 linear ft. / 4212 sq. in.
Shelf Dimensions: 24" x 26"

Shipping Pallet: 420 lbs.; H85"

Compressor: Embraco EMC3121U ¼ HP
Insulation Material: EcoFoam
Energy Consumption: 2.05 kWh/day
Voltage / Frequency: 120V / 60Hz / 3A
Temperature Range: 35-44°F

Connectivity:

Cellular Standard, Optional WiFi & Ethernet
6 Circular-Polarized UHF RFUD Antennas (FCC)

Security Camera:

Reolink RLC-520A
Person Recognition, 100 ft. Night Vision,
Audio & Video Edge SD Recording

Hardware Features:

Cabinet Body Color: Black Painted Steel, Interior Cabinet Material: White Painted Steel, Heavy-duty Epoxy Coated Wire Shelves (6); Shelf Support K-clip: Galvanized Steel; Circular Arc Handle; Energy Efficient LED Interior Lighting

Merchandising Starter Kit

- Cantaloupe E-Port Reader
- 22" Swipe, Grab & Go decal
- Bluetooth Sticker Scanner
- 20 Product Detail Shelf Clips
- 21 Metal Shelf Row Dividers
- 6 Clear Plastic Shelf End Caps
- 6 Shelf Rollers



Designed in California | Built in Pennsylvania

Blackboard

TRANSACT

cbord

touchnet
A Global Payments Company

itc
SYSTEMS

atrium

Features

- 24/7 Secure Sales (Deadbolt Lock)
- No Retail Labor Required
- Remote Dashboard Management
- Daily Sales Deposits
- Capacity - 432 Drink Cans
- Highest Level of Data Security
- 8-Second Retail Transaction

Hello@LaunchFoodSpot.com

BA1 Smart Fridge Microstore

FoodSpot

UNATTENDED MICROSTORES

Internal Side View

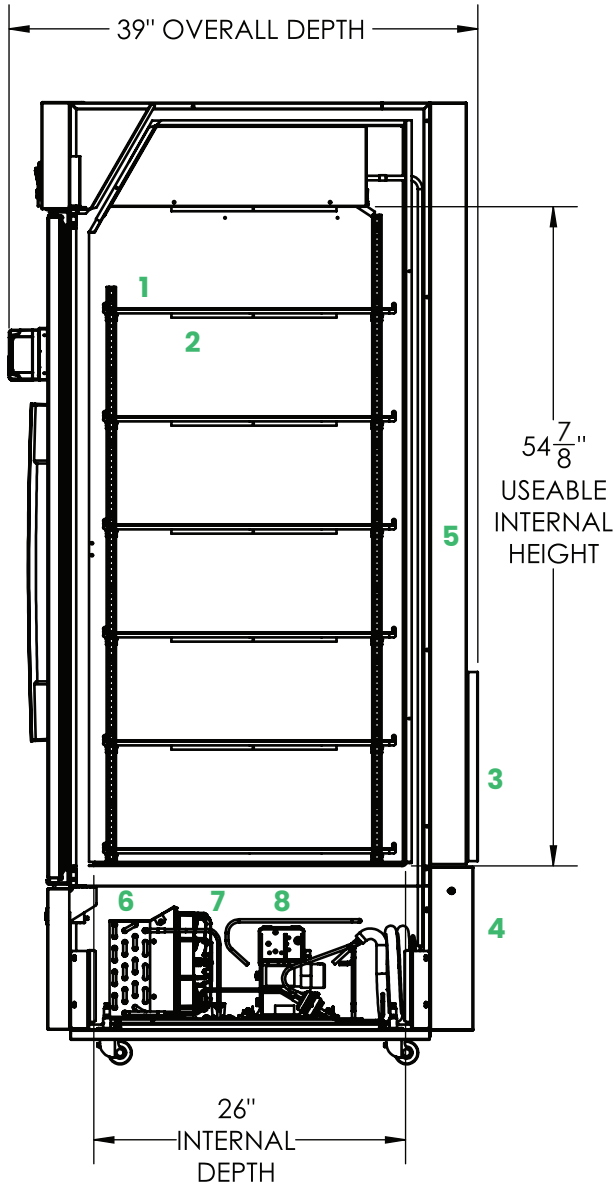

Front View

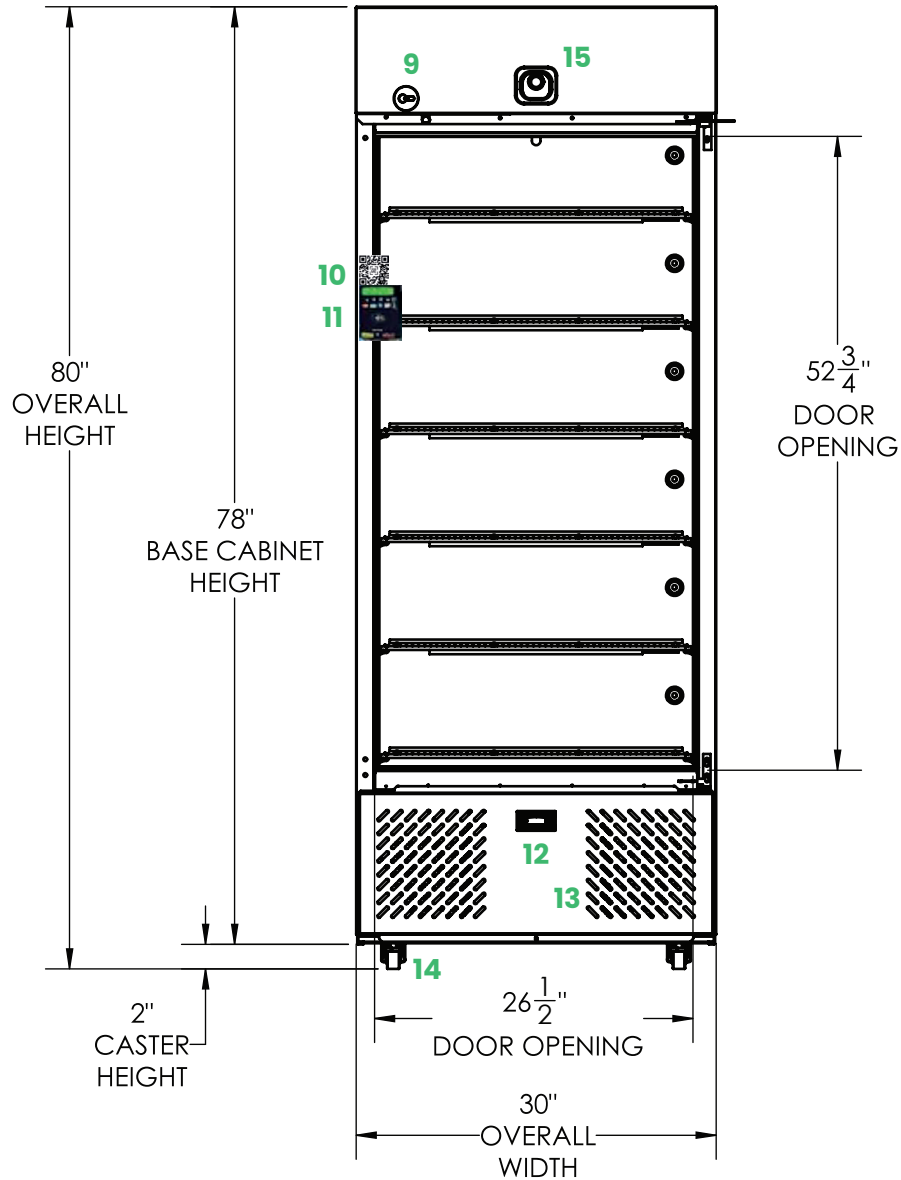

5-15P

- | | | |
|------------------|--------------------|----------------------------|
| 1. Shelf Roller | 6. Condenser | 11. Credit Card Reader |
| 2. RFID Sensor | 7. Fan | 12. Thermostat/Temperature |
| 3. Data Antennas | 8. Compressor | 13. Vents |
| 4. Control Box | 9. Smart Lock | 14. Casters |
| 5. Cord Duct | 10. QR Code Triage | 15. Security Camera |

(No side or rear clearance required.)